

# Azimuth Stern Drive Tug 2609 ICE

STANDARD



## » PICTURE OF SIMILAR VESSEL

### GENERAL

Basic functions	Push-pull, escorting, towing and Ø fire-fighting operations
Classification	Russian Maritime Register of Shipping (RMRS) KM ★ Arc4 (Hull) Ice3 (Power) R1 AUT1 TUG Ø IWS Ø ESCORT Ø FF3WS Incl. tonnage and loadline certificate GMDSS certificate A1, Ø A2 Epoxy paint system
Painting	

### DIMENSIONS

Length overall	26.45 m
Beam overall	9.54 m
Depth at sites	4.30 m
Draught aft	4.15 m
Displacement (98% consumables)	430 t
Scantlings	Hull 12 to 17 mm Hull construction RMRS Arc4/LR ICE 1AS FS

### TANK CAPACITIES

Fuel oil	50.7 m <sup>3</sup>
Fresh water	9.6 m <sup>3</sup>
Sewage	3.2 m <sup>3</sup>
Dirty oil	1.6 m <sup>3</sup>
Lubrication oil	1.6 m <sup>3</sup>
Hydraulic oil	0.36 m <sup>3</sup>
Bilge water	5.3 m <sup>3</sup>
Sludge	1.6 m <sup>3</sup>
Ø Foam	6.5 m <sup>3</sup>

### PERFORMANCES

Bollard pull ahead	40.6 t
Bollard pull astern	37.4 t
Speed	12.7 kn

### PROPULSION SYSTEM

Main engines	2x Caterpillar 3512C TA/C
Total power	2610 bkW (3500 bhp) at 1800 rpm
Azimuth thrusters	2x Kongsberg Maritime US 205
Propeller diameter	2000 mm

### AUXILIARY EQUIPMENT

Generator sets	2x Caterpillar C4.4 TA, 230/400 V, 86 kVA, 50 Hz
General service pumps	2x Sterling AKHA 5101 20 m <sup>3</sup> /h at 1.4 bar
Fuel pumps	2x Sterling AKHA 4101 4.5 m <sup>3</sup> /h at 1.3 bar
Fuel oil purifier	Westfalia OTC 2-02-137, 1150 l/h
Ø Sewage treatment plant	Selmar Blue Sea 2500
Fresh water pressure set	Sterling AOHA 1202
Cooling system	Keel cooling channels
Hydraulic system	Double main engine driven pumps
Ø Fifi set	Diesel driven pump 600 m <sup>3</sup> /h or 1300 m <sup>3</sup> /h
Ø Fifi monitor	2x 300 m <sup>3</sup> /h or 600 m <sup>3</sup> /h water/foam

### DECK LAY-OUT

Anchors	2x 360 kg Pool (High Holding Power)
Anchor/towing winch	Hydraulically driven two speed winch with single drum and warping head, pull 10 ton up to 10 m/min at second layer and slack rope speed up to 22 m/min at second layer, 100 ton brake
Capstan	Electrically driven, 3 ton at 15 m/min
Towing hook aft	Mampaey SWL 650 kN/ 65 ton
Ø Towing winch aft	Hydraulically driven two speed winch with spooling device and warping head, pull 10 ton up to 12.5 m/min at second layer and slack rope speed up to 22 m/min at second layer, 120 ton brake
Crane	Heila HLM 10-3S 0.8 ton at 10.36 m
Fendering	D-fender at sides and transom, double row bow cylindrical fender and Ø nine heavy tyre fenders on foreship

### ACCOMMODATION

For 8 persons, insulated and finished with durable modern linings, acoustical ceiling in the wheelhouse, floating floors, oil fired central heating system and air-conditioned. With 5 cabins, galley, mess/dayroom, dry store and sanitary facilities.

### NAUTICAL AND COMMUNICATION EQUIPMENT

Searchlight(s)	1x Norselight 2000 W + Ø 1x Norselight 2000 W
Radar system	Furuno FAR 1518-BB
Compass	Cassens & Plath, Kotter type
Autopilot	Simrad AP-70
GPS/ Glonass	Samyung SGN-500
Echosounder	Furuno FE-800
VHF radio telephone	2x Sailor Compact 6222
VHF hand-held	2x Jotron TR-30
Navtex	Furuno NX-700A
SSB	Furuno FS-1575
AIS	Cobham Sailor 6280
EPIRB	Jotron Tron-60S
SART	Jotron Tronsart20
Remote monitoring	Ready for Damen Triton
Anemometer	Observer Windsonic OMC 115
Ø Weather fax	Samyung SFAX-500

Ø = Optional equipment

# Azimuth Stern Drive Tug 2609 ICE

STANDARD

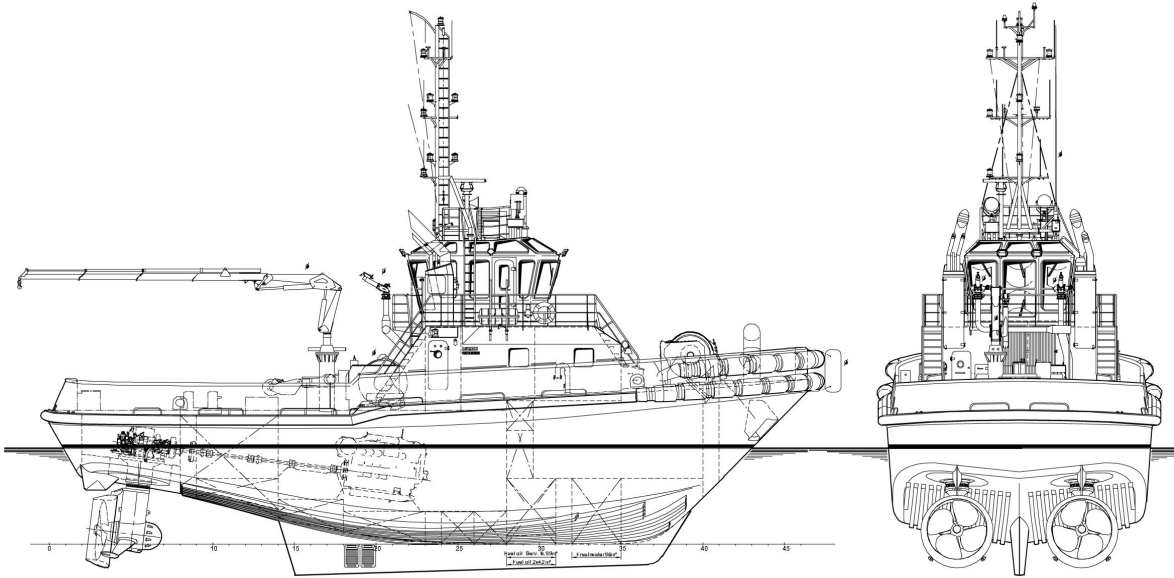

Main deck

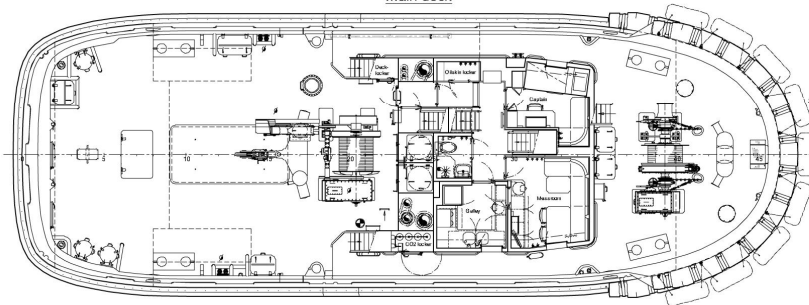

Top deck

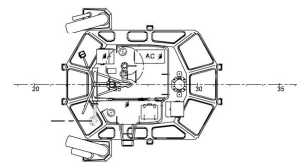

Below Main deck

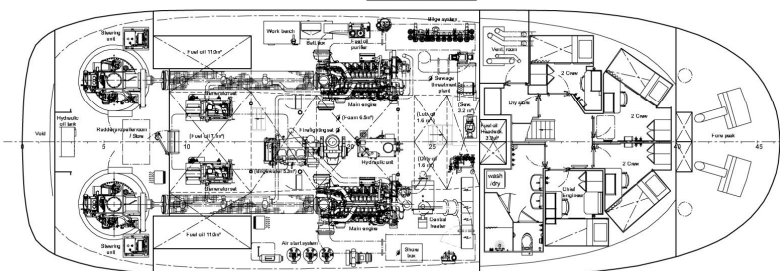

Bridge deck

