



AZIMUTH STERN DRIVE TUG 2810

“CAPO BOEO”

GENERAL

Yard number	513501
Delivery date	December 2016
Basic functions	Towing, mooring and fire-fighting operations
Classification	I * HULL • MACH Escort Tug Unrestricted Navigation AUT UMS Inwater Survey Fire Fighting ship 1 WATERSPRAY
Flag	Italy
Owner	Rimorchiatori Augusta S.p.a.

DIMENSIONS

Length overall	28.67 m
Beam overall	10.43 m
Depth at sides	4.60 m
Draught aft	4.78 m
Displacement	544 t

TANK CAPACITIES

Fuel oil	85.0 m ³
Fresh water	16.6 m ³
Foam	6.6 m ³
Lubrication oil	9.1 m ³
Dirty oil	3.2 m ³
Sewage	2.2 m ³
Sludge	3.2 m ³
Bilge water	5.2 m ³

PERFORMANCES

Bollard pull ahead	60.7 t
Bollard pull astern	55.9 t
Speed ahead	14.0 kn
Speed astern	13.8 kn

PROPULSION SYSTEM

Main engines	2x Caterpillar 3516C TA HD/C
Total Power	3730 bkW (5000 bhp) at 1600 rpm
Azimuth thrusters	2x Rolls Royce US 205
Propeller diameter	2400 mm
Forced ventilation	55.000 m ³ /h

AUXILIARY EQUIPMENT

Generator sets	2x Caterpillar C4.4 TA, 230/400 V, 107 kVA, 50 Hz
Bilge pumps	2x Sterling AKHA5101 each 20 m ³ /h
Fuel pumps	Sterling AKHA 4101 and AOHA 3101
Cooling system	Box cooling + anti-growth system
Fresh water pressure set	Sterling AOHA 1202
Hydraulic system	Two main engine driven pumps
Fifi set	Diesel driven pump 2400 m ³ /h (FIFI 1 with waterspray)
Fifi monitor	2x 1200 m ³ /h, water/foam

DECK LAY-OUT

Anchor	2x 360 kg Pool (High Holding Power)
Anchor/towing winch	Hydraulically driven two speed winch with split drum and warping head, pull 35 ton at 9.2 m/min, slack rope speed up to 28 m/min, 150 ton brake
Capstan	5 ton at 15 m/min, electrically driven
Rescue boat + davit	1x 4 meter inflatable rescue boat fitted with 25 hp outboard engine + davit
Fendering	D-fender at sides, cylinder fender at transom corners, cylinder and W-block bow fender with water spray

ACCOMMODATION

For 6 persons, insulated and finished with durable modern linings, acoustical ceiling in the wheelhouse, floating floors and air-conditioned. Captain's cabin, two officer's cabins, a Chief engineer's cabin, one double crew cabin, galley, mess/dayroom, dry store and sanitary facilities.

NAUTICAL AND COMMUNICATION EQUIPMENT

Searchlight	2x Xenon 450 W
Radar system	Furuno FAR-2117 with 19 inch screen
Compass	Magnetic Kotter
Autopilot	Simrad AP-70
DGPS	Furuno DGP-170
Echosounder	Furuno FE-800
Speed log	Furuno DS-80
VHF radio telephone	2x Sailor 6222 (one with DSC)
VHF hand-held	2x Jotron TRON TR-20
Navtex	Furuno NX-700A
Emergency telegraph	Eekels TG-1
AIS	Furuno FA-150
SSB	Furuno FS-1575
EPIRB	Jotron Tron 60S
Sart	Jotron Tron Sart

AZIMUTH STERN DRIVE TUG 2810

“CAPO BOEO”

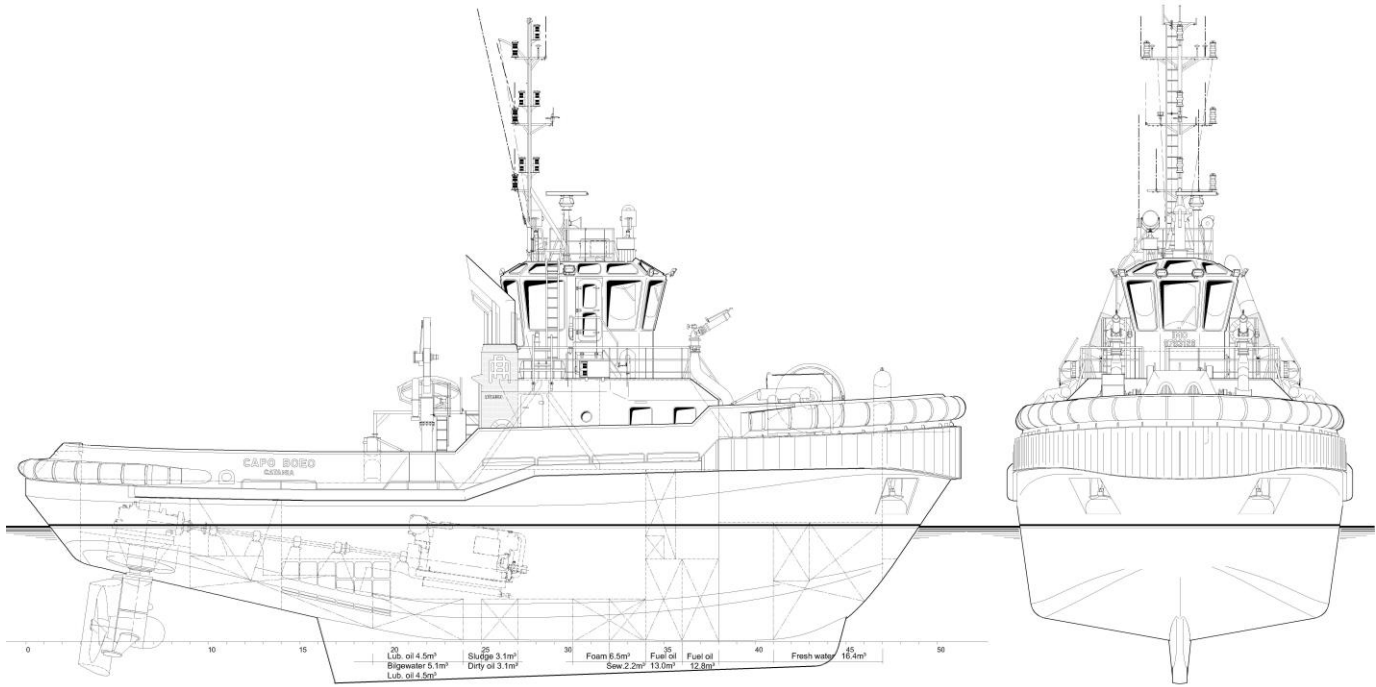

Main deck

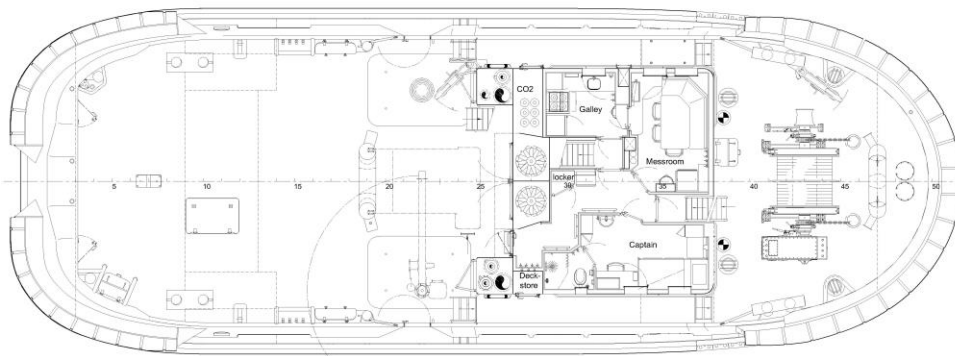

Top deck

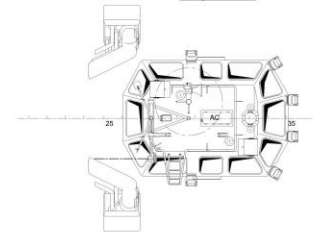

Below Main deck

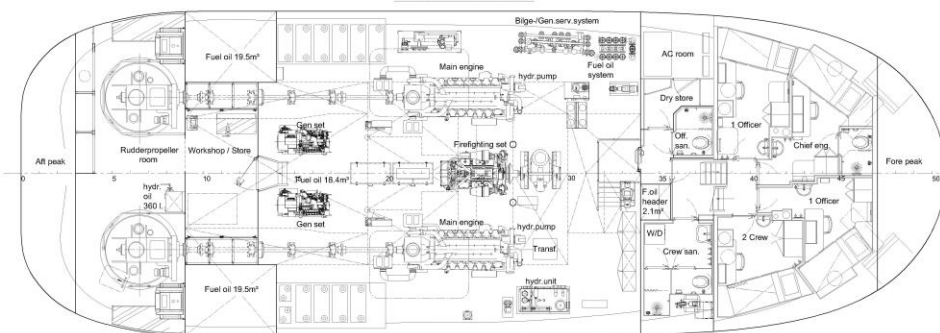

Bridge deck

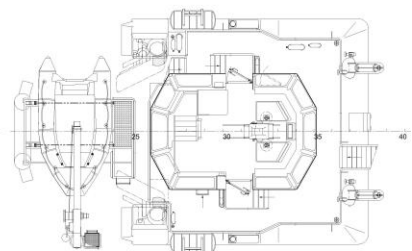

DAMEN

DAMEN SHIPYARDS GROUP

Avelingen-West 20
4202 MS Gorinchem
The Netherlands

P.O. Box 1
4200 AA Gorinchem
The Netherlands

phone +31 (0)183 63 99 22
fax +31 (0)183 63 21 89

info@damen.com
www.damen.com