



## DAMEN FAST CREW SUPPLIER<sup>®</sup> 2610 "MCS PAMPERO"

PHOTO OF SISTER VESSEL

### GENERAL

YARD NUMBER	532514
OWNER	MCS
DATE OF DELIVERY	October 2012
HULL MATERIAL	Aluminium
SUPERSTRUCTURE	Aluminium
BASIC FUNCTIONS	Crew / cargo transport/ support
CLASSIFICATION	Bureau Veritas I * Hull ● MACH, Light Ship / Fast Utility Vessel, Sea Area 3 Work boat Cat 1, 150 nm.
MCA	
FLAG	UK

### DIMENSIONS

LENGTH O.A.	26.30 m
BEAM O.A.	10.40 m
DEPTH AT SIDES	2.90 m
DRAUGHT	1.98 m - 2.20 m, depending on loading condition.

### TANK CAPACITIES

FUEL OIL (TOTAL CAPACITY)	22.00 m <sup>3</sup>
FRESH WATER	1.80 m <sup>3</sup>
WASTE WATER	0.50 m <sup>3</sup>

### PERFORMANCES (TRIALS)

SPEED MAX.	26.0 kn.
CRUISING SPEED	22.0 kn.
RANGE (AT CRUISING SPEED)	1100 nm.

### PROPULSION SYSTEM

MAIN ENGINES	2x Caterpillar C32 TTA B
TOTAL POWER	Up to 1790 bkW (2400 bhp)
GEARBOXES	Reintjes ZWVS 440/1 (two speed)
PROPELLERS	Fixed-pitch propellers
BOW THRUSTERS	2x 52 kW

### ELECTRICAL EQUIPMENT

NETWORK	24V d.c., 230/400V – 50 Hz
GENERATOR SETS	2x Caterpillar C2.2 T
CAPACITY	2x 22.5 kW / 28.0 kVA

### AUXILIARY EQUIPMENT

BILGE PUMP	Electric 400V
FIRE FIGHTING	STAT-X system in engine room

### DECK LAY-OUT

ANCHOR EQUIPMENT	Anchor according to class
FENDERING	Rubber "D" type and heavy duty foam bow fender
DECK CRANE	Heila 20-5S, capacity 2.2 ton @ 8.60
DECK SPACE FWD	90.0 m <sup>2</sup>
DECK CARGO FWD	15.0 ton
MAX DECK LOAD	1.5 ton/ m <sup>2</sup>

### LIFE SAVING EQUIPMENT

LIFE BUOYS	2
LIFE JACKETS/SUITS	15
LIFE RAFTS	1x 16 persons
FIRE EXTINGUISHER	According to class
TPA	15
MOB RECOVERY/ DIVE PLATFORM	One elevating platform is fitted at the transom

### ACCOMMODATION

CREW	Up to 4 persons
TRANSFER CREW	Up to 12 persons
WHEELHOUSE	10 motion damping seats, settee & technical office.
MAIN DECK & BELOW MAIN DECK	Mess room/ day room, pantry, 3x1p cabins+ 3 spare bunks, laundry facility and store.
HEATING AND COOLING	Air-conditioning in the wheelhouse and the main deck accommodation.

### NAUTICAL AND COMMUNICATION EQUIPMENT

SEARCHLIGHT	1x Pesch 1000W 230V, electrical operated
COMPASS	Cassens & Plath, Reflecta
ECHO SOUNDER	JRC, JFE-380
VHF'S + VHF'S HANDHELD	1x Sailor RT 6222, 1 x Sailor RT 6210, 2 x SP3520
RADAR	2x JRC, JMA 5212-4 MK2
GPS/ NAVTEX	1x JRC, JHS-21, 1 x JRC, NCR-333
AIS	JRC, JHS 182
AUTOPILOT	Alphatron Seapilot MFC
MF/ HF	Sailor, 6000 series
CCTV	6 camera deck system incl. hard disk recorder
SAR FINDER	Sea Marshall, SARfinder 1003
ENTERTAINMENT SYSTEM	LCD TV's, DVD player + Internet/ WIFI

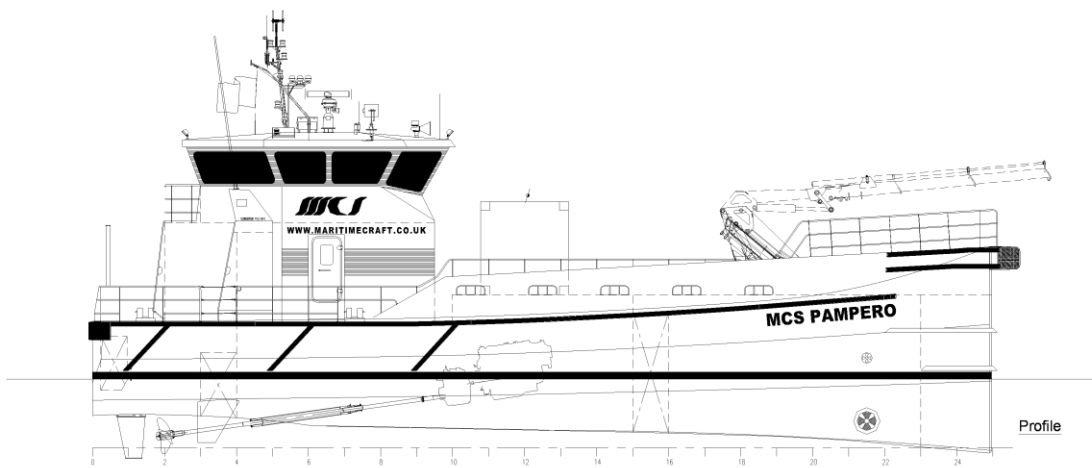

Profile

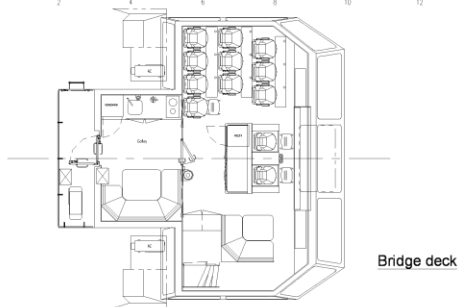

Bridge deck

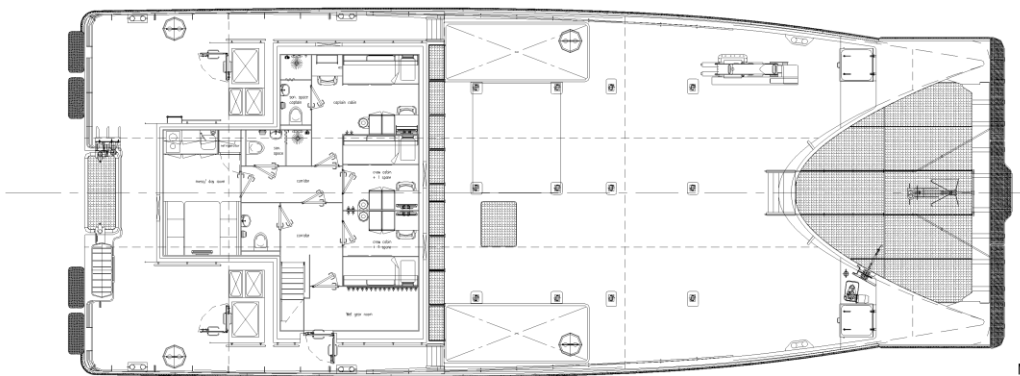

Main deck

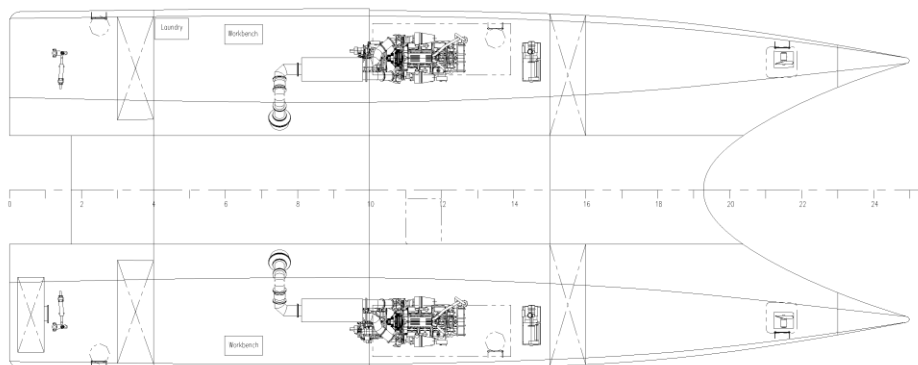

Below maindeck

# DAMEN FAST CREW SUPPLIER<sup>®</sup> 2610

## "MCS PAMPERO"

# DAMEN

DAMEN SHIPYARDS GORINCHEM

Member of the DAMEN SHIPYARDS GROUP



Industrieterrein Avelingen West 20  
4202 MS Gorinchem

P.O. Box 1  
4200 AA Gorinchem  
The Netherlands

phone +31 (0)183 63 99 11  
fax +31 (0)183 63 21 89

info@damen.nl  
www.damen.nl